

TR-971 Dental Operating LED Light

Manual



Read the manual carefully before using the light.

Scope

The operating lights used in the dental office and intended for illuminating the oral cavity of patients.

Structure of the light

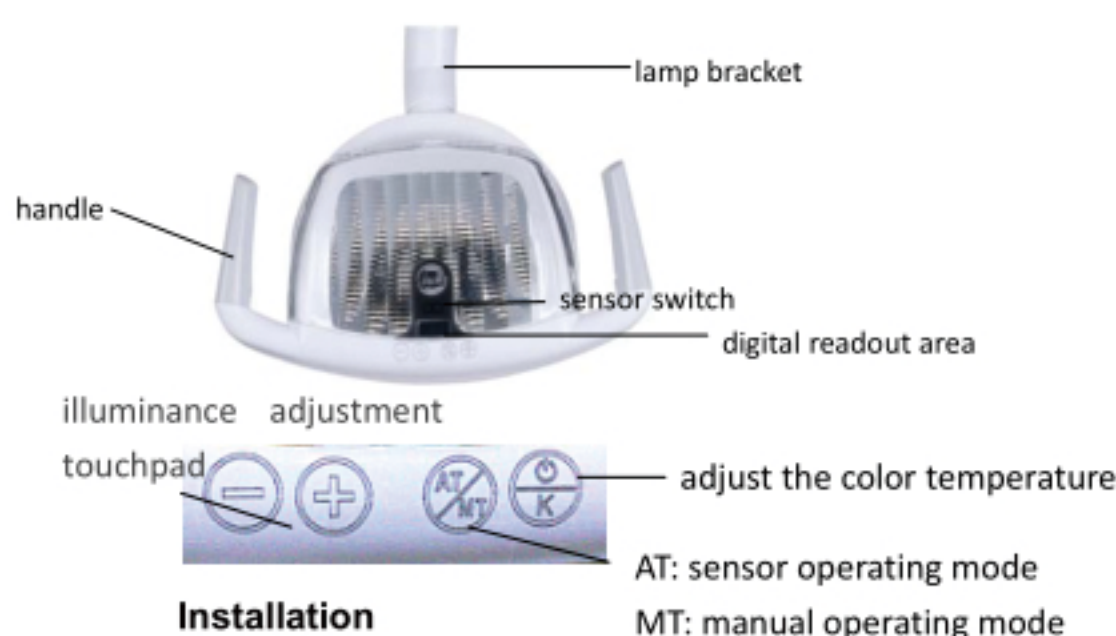

Installation

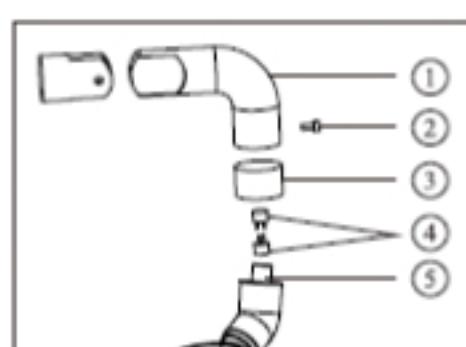

- ①lamp arm ②screw ③decoration cover
④connector ⑤connecting shaft
Installation method:
Connect the lamp arm, decoration cover and the connector according to the instruction picture.

Make sure the power source is AC12V-24V.

Working condition

Working condition		Transportation and storage condition	
Temperature	5-40℃	Temperature	-40-70℃
Relative humidity	30-75%	Relative humidity	-10-+100%
Atmospheric pressure	70-106Kpa	Atmospheric pressure	50-106Kpa

Technical specification

Input voltage	AC12V-24V
Power	9VA
Illuminance	7000lux-30000lux
Color temperature	4000K & 5500K
Net weight	1400g
Gross weight	1950g

Operating instruction



1 , When u touch AT or MT, you can

change the operating mode from sensor operating mode and the manual operating mode.

2 , When the light is under AT mode, the light can be operated by the sensor switch. Skim over the sensor switch within 10cm, the light will be on or off. When the light is on, keep the hand in front of the sensor within 10cm, the illumination of the light will be adjusted. Touch K button to shift between low color temperature to high color temperature.

3, When the light is under MT mode, touch the on/off and K button to shift among low color temperature, high color temperature and off.

4 , No matter the light is under AT or MT mode, when the lights is on, you can adjust the illumination by the adjustment button. Touch once, the illumination will be increased or decreased by 1000lux. Press the “+” or “-” button, the illumination will be quickly adjusted. The illumination will be automatically memorized.

5, Three-axis, adjust the angle of the handle to make the light to any position u get used to. Provide unlimited positioning.

6, The handle covers of the lights can be disinfected under high temperature.

Maintenance & Attention

Clean via the 3-function sprayer or soft cotton and wet tissue.

The handle can be taken off and disinfected under the high temperature.

Notice:

Don't use the caustic cleaning solution or the rough cloth to clean or rub the light.